



CURRENT TRANSFORMERS (with Voltage Signal Output)

Model CV8 (Window Size: 3.25" Diameters)

Application: Generally used to provide 0 - 1.0Vac output with a current input. (Other secondary voltages also available)

Frequency: 50-400 Hz

Insulation Level: 600 Volts, 10Kv BIL Full Wave

- Terminals are brass. Stud and Female options w/ hardware available. (See Page 2)
- Mounting bracket kits for the Model CV8SHT are sold separately. (Part Number 1121A00022-1)
- Approximate weight: 3 lbs.



CV8 SHT

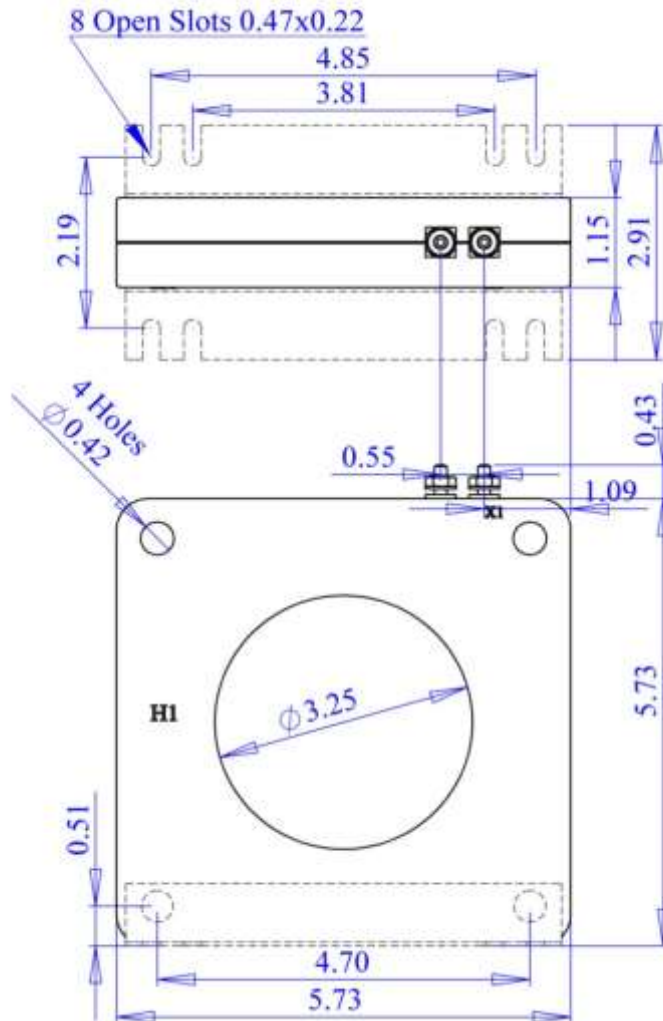



CURRENT TRANSFORMERS

Model CV8 (Window Size: 3.25" Diameter)

| Catalog Number | Primary Current/ Sec. Voltage | Accuracy at 60Hz | TRF @ 30C | TRF @55C |
|----------------|----------------------------------|---------------------|-----------|----------|
| CV8 **-101-1 | 100A:1V | 0.3% | 1.0 | 0.8 |
| CV8 **-121-1 | 120A:1V | 0.3% | 1.0 | 0.8 |
| CV8 **-151-1 | 150A:1V | 0.3% | 1.0 | 0.8 |
| CV8 **-201-1 | 200A:1V | 0.3% | 1.0 | 0.8 |
| CV8 **-251-1 | 250A:1V | 0.3% | 1.0 | 0.8 |
| CV8 **-301-1 | 300A:1V | 0.3% | 1.0 | 0.8 |
| CV8 **-401-1 | 400A:1V | 0.3% | 1.0 | 0.8 |
| CV8 **-501-1 | 500A:1V | 0.3% | 1.0 | 0.8 |
| CV8**-601-1 | 600A:1V | 0.3% | 1.0 | 0.8 |
| CV8 **-751-1 | 750A:1V | 0.3% | 1.0 | 0.8 |
| CV8 **-801-1 | 800A:1V | 0.3% | 1.0 | 0.8 |
| CV8 **-102-1 | 1000A:1V | 0.3% | 1.0 | 0.8 |
| CV8 **-152-1 | 1000A:1V | 0.3% | 1.0 | 0.8 |

**Note: When ordering, use prefix below to indicate unit designation/configuration. (i.e. CV8SHT-101-1)

SH-* = Square Case with mounting holes

T = Male (Brass studs No. 8-32 UNC with one flat washer, one lock washer and one nut each)

Y = Female (Brass with one Cup washer, one lock washer and one No. 8-32 UNC binding head screw each)



Y = Female Terminals



T = Male Terminals